

Birds & Bees Mix

Prairie Garden Plan

Create a colorful prairie garden teeming with birds, bees, and other prairie wildlife.

1. Little Bluestem Grass x10
(*Schizocarpium scoparium*)
Mature size: 6'x3'
2. Blazing Star x10
(*Liatis spicata*)
Mature size: 6'x2'
3. Bee Balm x10
(*Monarda fistulosa*)
Mature size: 4.5'x3'
4. Black-eyed Susan x10
(*Rudbeckia figida v. fulgida*)
Mature size: 2.5'x2'
5. Side Oats Grass x10
(*Boureloua curtipendula*)
Mature size: 2.5'x2'



Description: This mix includes resilient, wild-life friendly plants from the Oklahoma region. Birds and bees will visit in droves enticed by your grassy, pollen-filled haven. Enjoy vibrant, heat-loving blooms during the dog days of summer when non-native perennials tend to decline. Seeds heads and dormant foliage provide visual interest, forage, and protection for wildlife. This mix plants roughly 150 sq. feet at maturity.

Directions: Plant in full sun (8+ hours direct sun) with moderate to well-drained soil. Water your plants regularly the first year in the ground. After the first year, water deeply once a week, or as needed. Once established, these tough plants will thrive in Oklahoma's brutal summer without the need of daily watering- an eco-friendly way to save money on your water bill. Prune late winter before new growth arrives in spring. Compliment your prairie garden with native river rock & landscape boulders for an added Oklahoma-style flare. Maximize biodiversity with a water feature such as a bird bath, or pond.

Looking for more? Try our...

Butterfly Lovers Mix for more pollinators

GO BIG Mix for larger impact

Wild Mix for more prairie garden diversity

Low Grow Mix for more ground covers

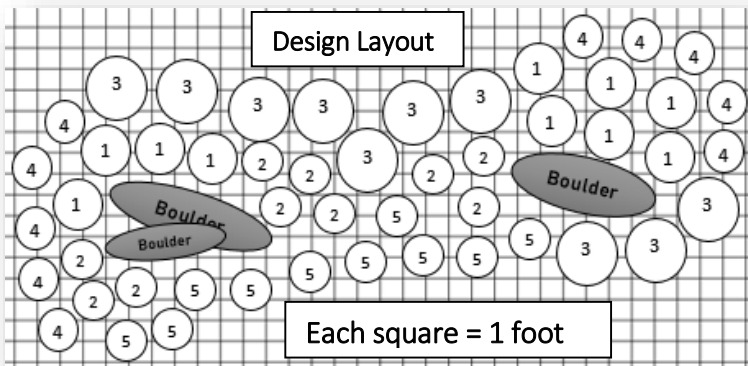

1) Little Bluestem Grass Vertical interest, capturing movement, wildlife forage/shelter, multi-season color interest, winter structure, establishes quickly, drought tolerant.



2) Blazing Star Vertical interest, attracts birds, pollinators, striking spiky purple flower, ornamental foliage, multi-season interest, drought tolerant. Zone 3-9.



3) Bee Balm Unique lavender flowers, fragrant/edible (mint family), attracts birds/hummingbirds/butterflies/bees, cut flowers, drought tolerant. Zone 3-9.



4) Black-eyed Susan Striking bloom color, attracts butterflies/birds/bees, winter interest, cut flowers, drought tolerant. Zone 3-9.



5) Side Oats Grass Soil stability, wildlife forage/shelter, arching interest, capturing movement, multi-season interest, cut flower. drought tolerant. Zone 3-8.

Description: This mix includes resilient, wild-life friendly plants from the Oklahoma region. Birds and bees will visit in droves enticed by your grassy, pollen-filled haven. Enjoy vibrant, heat-loving blooms during the dog days of summer when non-native perennials tend to decline. Seeds heads and dormant foliage provide visual interest, forage, and protection for wildlife. This mix plants roughly 150 sq. feet at maturity.

Directions: Plant in full sun (8+ hours direct sun) with moderate to well-drained soil. Water your plants regularly the first year in the ground. After the first year, water deeply once a week, or as needed. Once established, these tough plants will thrive in Oklahoma's brutal summer without the need of daily watering- an eco-friendly way to save money on your water bill. Prune late winter before new growth arrives in spring. Compliment your prairie garden with native river rock & landscape boulders for an added Oklahoma-style flare. Maximize biodiversity with a water feature such as a bird bath, or pond.

Looking for more? Try our....

Butterfly Lovers Mix for more pollinators

GO BIG Mix for larger impact

Wild Mix for more prairie garden diversity

Low Grow Mix for more ground covers

